

Explosion-Proof Pilot Devices

Nema Type 4, 4X, 7 & 9

2 & 3 Position Push-Pull Switch Operators

Specifications

XPPP S - 2 RA - FS (-CEN)
a b c d e f ATEX Optional



2 Position Push-Pull
Switch Operator
XPPPS-2GE

a = Barrel Type

Code	Description
S	Short Barrel
L	Long Barrel

b = Number of Positions

Code	Description
2	2-Position
3	3-Position

c = **Mushroom Heads

Code	Description
Blank	Standard Mushroom Head
J	Jumbo Mushroom Head

Note: To engrave mushroom heads, C/F

d = Button Color

Code	Description
G	Green
R	Red

e = Contact Blocks

Code	Description
Blank	No Contacts
A	1 N.O.
B	1 N.C.
2A	2 N.O.
2B	2 N.C.
C	1 N.O. / 1 N.C.
*D	2 N.O. / 2 N.C.
E	1 N.C.L.B.
F	1 N.O.E.M.
2E	2 N.C.L.B.
2F	2 N.O.E.M.
*G	1 N.O. / 1 N.C.L.B.
*H	1 N.C. / 1 N.C.L.B.
*J	3 N.O. / 3 N.C.
*K	4 N.O. / 4 N.C.
L	N.O.E.M.-N.C.
M	N.O.E.M.-N.O.
N	N.C.L.B.-N.O.E.M.
P	2 N.O. / 2 N.C. (300V)

f = Accessories

Code	Description
-FS	Finger Safe Option

CONTACT ABBREVIATION

N.O.= Normally Open
N.C.= Normally Closed
N.C.L.B.= Normally Closed- Late Break
N.O.E.M.= Normally Open- Early Make
E.C.N.O.= Early Close-Normally Open
L.O.N.C.= Late Open-Normally Closed

All contact blocks are rated 600V
unless noted.

N4= NEMA 4 locking collar is standard
on all Akron Electric operators

3/4"-14 NPSM standard thread

Pushbuttons can also be used with
Allen Bradley or C3 Controls
contact blocks. (C/F)

*Denotes multiple block configuration

**Mushroom heads are made of
Anodized Aluminum



Explosion-Proof Pilot Devices

Nema Type 4, 4X, 7 & 9

XP 2 & 3 Position Push-Pull Operators Dimensional Data

Dimensions (Inches [mm])

Note: All dimensions are for reference only



LR86146



FILE NO. E203605
FILE NO. E139669
FILE NO. E181300



(Optional)

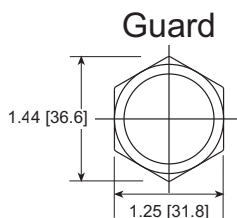
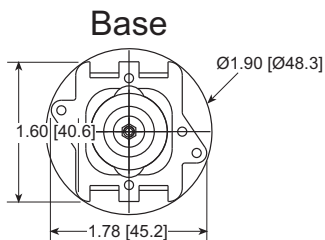

Mushroom Head Cap

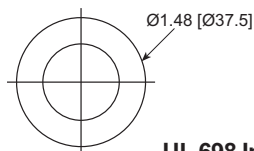

Short Barrel

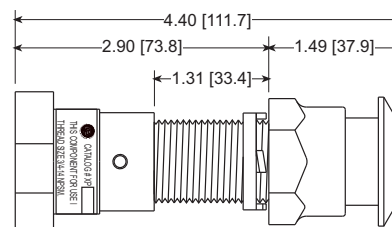

Long Barrel

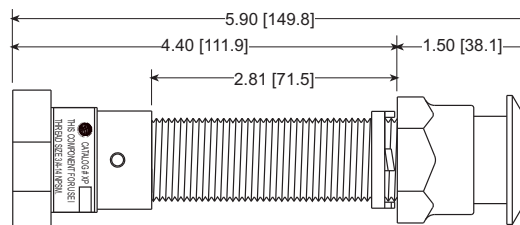

Push-Pull Operator
ex. XPPPL-2JR

CLASS I, Div 1 & 2, GROUPS B, C & D;
CLASS II, Div 1 & 2, GROUPS E, F & G;
CLASS III,
NEMA TYPE 4, 4X, 7 & 9

UL 698 Industrial Control Equipment in Hazardous (Classified) Locations.

UL 1203 Explosion-Proof and Dust-Ignition-Proof Electrical Equipment for Use in Hazardous (Classified) Locations.

CSA C22.2 No. 30-LR86146 Explosion-Proof Enclosures for use in Class I Hazardous locations.

FEATURES

- Operator bodies are black anodized & teflon impregnated.
- Operating Shafts are stainless steel.
- 3/4-14 NPSM threaded body size
- **Long Series:** Accommodates up to 2-1/2" thick enclosure wall thickness.
- **Short Series:** Accommodates up to 1" thick enclosure wall thickness.
- Explosion-Proof Operators are suitable for panel or surface mount applications.
- See Contact Block Information sheet for mounting and rating information.
- Mushroom Push Buttons are 1-1/2" Diameter Aluminum
- Jumbo 2-1/2" Dia. Aluminum Red Mushroom Button available
- Push-Pull Operator available 2 or 3 position